

**PORT OF PORT TOWNSEND
Resolution 581- 12.**

**A Resolution of the Port Commission of the Port of Port Townsend,
Washington pursuant to RCW 53.08.090 and RCW 53.20.020 to declare a
property surplus to its needs and to amend its Comprehensive Scheme of
Harbor Improvements to delete the properties from its Scheme to allow a
negotiated transfer for consideration.**

WHEREAS, Pursuant to RCW 53.20.010, the Port of Townsend Washington has adopted a Comprehensive Scheme of Harbor Improvements for the development of harbor improvements, development of industrial lands and other lands owned by the Port of Port Townsend Washington in Jefferson County.

WHEREAS, the Port's ownership of land included within the Port's Comprehensive Scheme of Harbor Improvements includes the parcels as described I Exhibit A, consisting of approximately 20 acres in Jefferson County, Washington.

WHEREAS, pursuant to RCW 53.08.090, the Port's Chief Executive Officer or designee has made written certification to the Commission that the Property is no longer needed for port district purposes.

WHEREAS, pursuant to RCW 53.08.090, property which is part of the Port's comprehensive scheme of improvement or modification thereof shall not be disposed of until the Port's comprehensive scheme has been modified to find the property surplus to Port needs, after public notice and hearing as provided by RCW 53.20.010 and 020.

WHEREAS, proper public notice was given and a public hearing was held on July 24, 2012 as required by statute.

WHEREAS, the Port intends to transfer for consideration the approximately 20 acres of property owned by the Port in the vicinity of Kah Tai Lagoon to the City of Port Townsend for inclusion into the City's Kah Tai Lagoon Nature Park, subject to matters of record title and all applicable grant restrictions, continued maintenance of free public access to the property, and proper maintenance of the property and associated improvements as one step in cooperatively resolving certain matters that mutually affect the City of Port Townsend and the Port of Port Townsend and which have been the subject of discussions over a number of years, and which if finalized will resolve outstanding federal litigation between the Port, City and other parties.

NOW, THEREFORE, be it resolved by the Port Commission that:

1. The Property described in the attached Exhibit A is no longer needed for Port district purposes and is surplus to the Port's needs, and the negotiated transfer of such Property for consideration is in the public interest.
2. The Port's Comprehensive Scheme shall be and hereby is amended to find the referenced Property surplus to Port needs and to remove the Property from the Port's Comprehensive Scheme of Harbor Improvements to permit the proposed transfer of same.

ADOPTED this 8th day of August 2012, by public vote of the Port of Port Townsend Port Commission.

Leif W. Erickson, President

Stephen R. Tucker, Vice President



David H. Thompson, Secretary/Treasurer



EXHIBIT A

Port Property in Vicinity of Kah Tai Lagoon

The "Port Kah Tai property" is the property the Port owns north of Sims Way in the vicinity of Kah Tai Lagoon, comprising approximately 20 acres.

It includes any interest in the following property (if located north of Sims Way):

1. The property described in the lawsuit filed by the Port in Federal District Court for the Western District of Washington at Tacoma, Case No. 3:11-cv-05848-RBL.
2. The property shown in a map called Kah Tai Park Ownership (Attachment A to September 7, 2011 Letter from Kaleen Cottingham (Director, State of Washington Recreation and Conservation Office) to Heather Ramsey (Program Manager, National Park Service), a copy of which map is attached as Attachment A to this Exhibit.
3. Property encompassed in the following Jefferson County assessor parcel numbers:

991 400 601
991 402 501
991 403 303
991 403 501

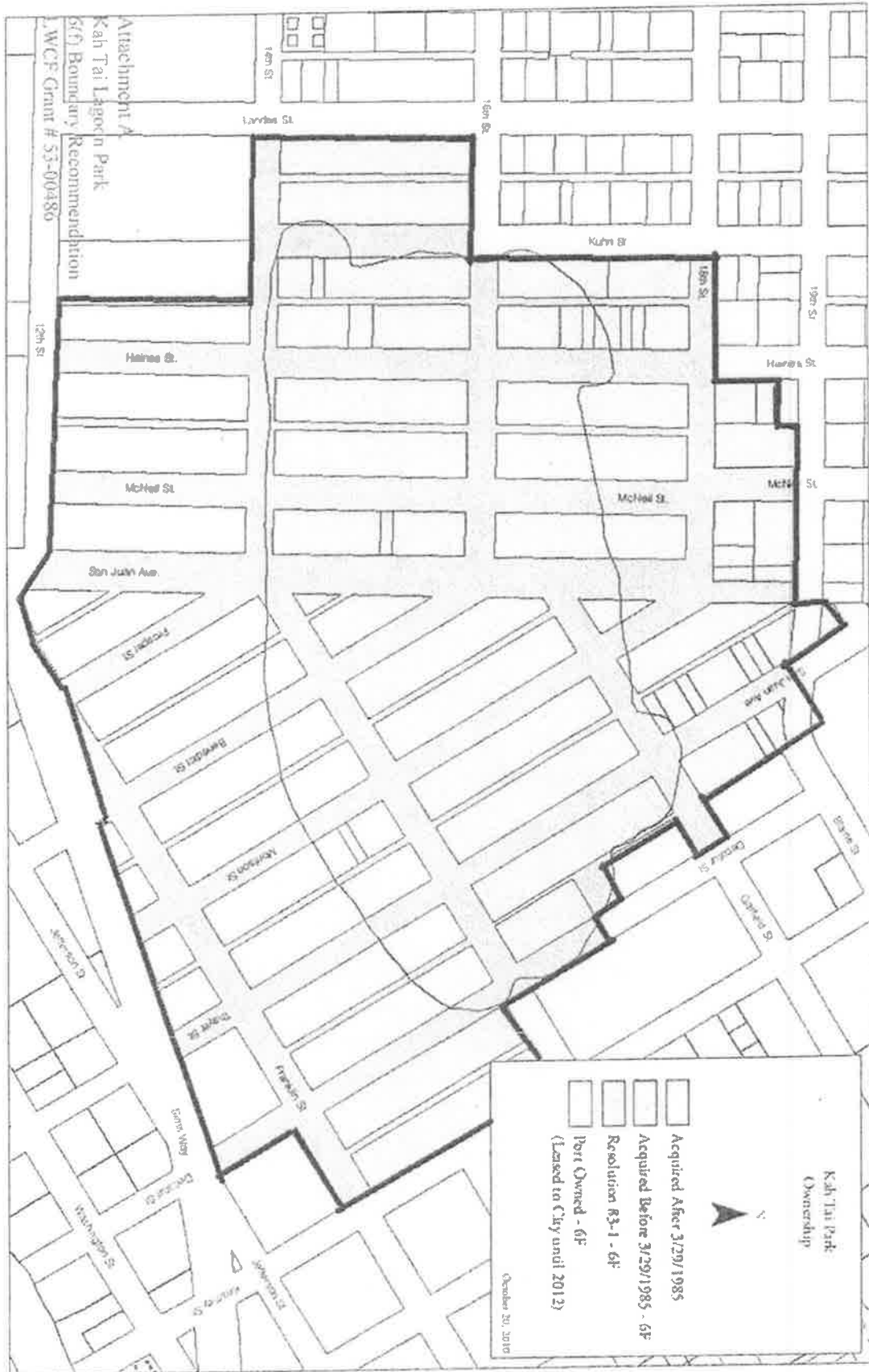

ATTACHMENT A